

EXPERIENCE



Understanding WWII with Artifacts

YOUR NATIONAL PARK

Student Name: _____

Instructions: Walk through the museum to find an artifact to analyze.

1. **TYPE OF ARTIFACT:** Describe the material from which it was made (bone, pottery, metal, wood, stone, leather, glass, paper, cardboard, cotton, plastic, or other material).

2. **SPECIAL QUALITIES OF THE ARTIFACT:** Describe how it looks and feels (shape, color, texture, size, weight, movable parts, anything printed, stamped or written on it).

3. **USES OF THE ARTIFACT:**

a. What might it have been used for? _____

b. Who might have used it? _____

c. Where might it have been used? _____

4. **WHAT DOES THE ARTIFACT TELL US?**

a. What does it tell us about technology of the time in which it was made and used? _____

b. What does it tell us about the life and times of the people who made it and used it? _____

c. Can you name a similar item today? _____

5. MAKE A SKETCH, OR BRING A PHOTOGRAPH OF THE ARTIFACT THAT YOU ANALYZED AT THE MUSEUM TO CLASS.

6. Instructions: Walk through the museum to find the artifact that matches each description below:

a. There were three types of guns used to defend the Governor's Palace called Plaza de Espana during the invasion of Guam in December 1941. What was the type and name of one of these guns? _____

b. Japanese aviators might have used this artifact to record information about aerodynamics. What is it? _____

c. This tool was called a "bolo" and used by George Tweed during his time hiding in the jungle. He kept this survival tool until his death in 1989. What artifact aided this U.S. Navy radioman's survival? _____

d. This group enlisted its first team of proud Guamanians on April 9, 1941. What artifact at the museum is similar to the U.S. Navy sailor uniform that they wore? _____

e. CHamoru resistance to the Japanese remained strong on Guam throughout the war. What artifact did CHamorus secretly operate in order to get news about the war? _____

f. Food and clothing shortages occurred during the war. Children often wore handmade things made of wood and scrap pieces of cloth. What artifact in the museum does this describe? _____

g. Allied forces engaged in defending New Guinea and other Southwest Pacific Islands. This artifact in the museum is an example of what weapon used by an ally?

This publication was provided by:



PACIFIC HISTORIC PARKS
Remember • Honor • Understand

EXPERIENCE



YOUR NATIONAL PARK

Understanding WWII with Artifacts Answer Key

Artifact locations are numbered in red on exhibit map

- | | |
|--|-------------------------------------|
| 1-5. Answers to questions 1-5 will vary. | 6d. Insular Guard uniform |
| 6a. .30 caliber Lewis gun | 6e. Radio |
| 6b. Aviator's notebook | 6f. Sandals |
| 6c. Machete | 6g. Australian bayonet and scabbard |

Exhibit Map

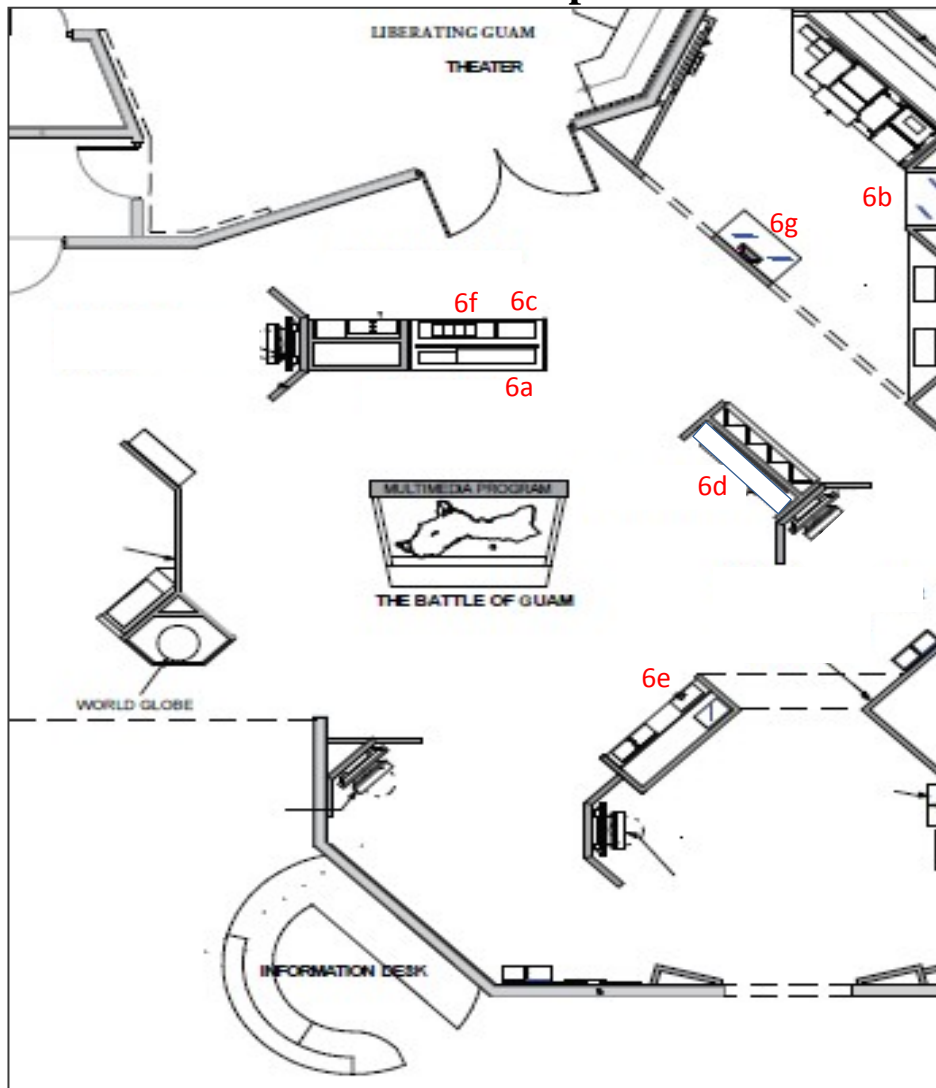

This publication was provided by:



PACIFIC HISTORIC PARKS

Remember * Honor * Understand *